

# Tecumseh



Tecumseh Branch, named for Chief Tecumseh, opened in a rented building at 1314 East State Boulevard in January 1927. Originally a one-story brick building measuring just 50 by 60 feet, it came as a welcome addition to the many State Street-area neighborhoods that had developed in that portion of Fort Wayne in the 1910s and 1920s. Due to high rents, the branch nearly closed during the Great Depression, but it remained operational. In the 1940s, the Board moved the branch to 1411 East State Boulevard. Always among the smallest branches, it became the focus of a plan in the 1960s that would have moved it to the area of Anthony Boulevard and St. Joe River Drive, but the Board later tabled the discussion. In 1984 a consultant advocated for its closure, but swift public protest at the proposal led the Board to relent. In April 1990, the building opened after an extensive upgrade. It was renovated again in 2005.

### GENERAL INFORMATION

Address	1411 E State Blvd Fort Wayne, IN 46805
Building Size	11,500 SF
Site Area	0.88 Acres
On Site Parking	42
Year Built	1928
Original Architect	Renovation 1990 & 2005 Morrison, Kattman Associates

### MANAGEMENT INFORMATION

Population Served (1 mile)	14,125
Days Open	6 / week
Hours Open	57 / week
Full Time Staff	5.5

### STATISTICS 2020

Door Count	36,662
Programs	38
Program Attendance	419
Collection Size	41,729
Circulation	54,590
Computer Usage	29

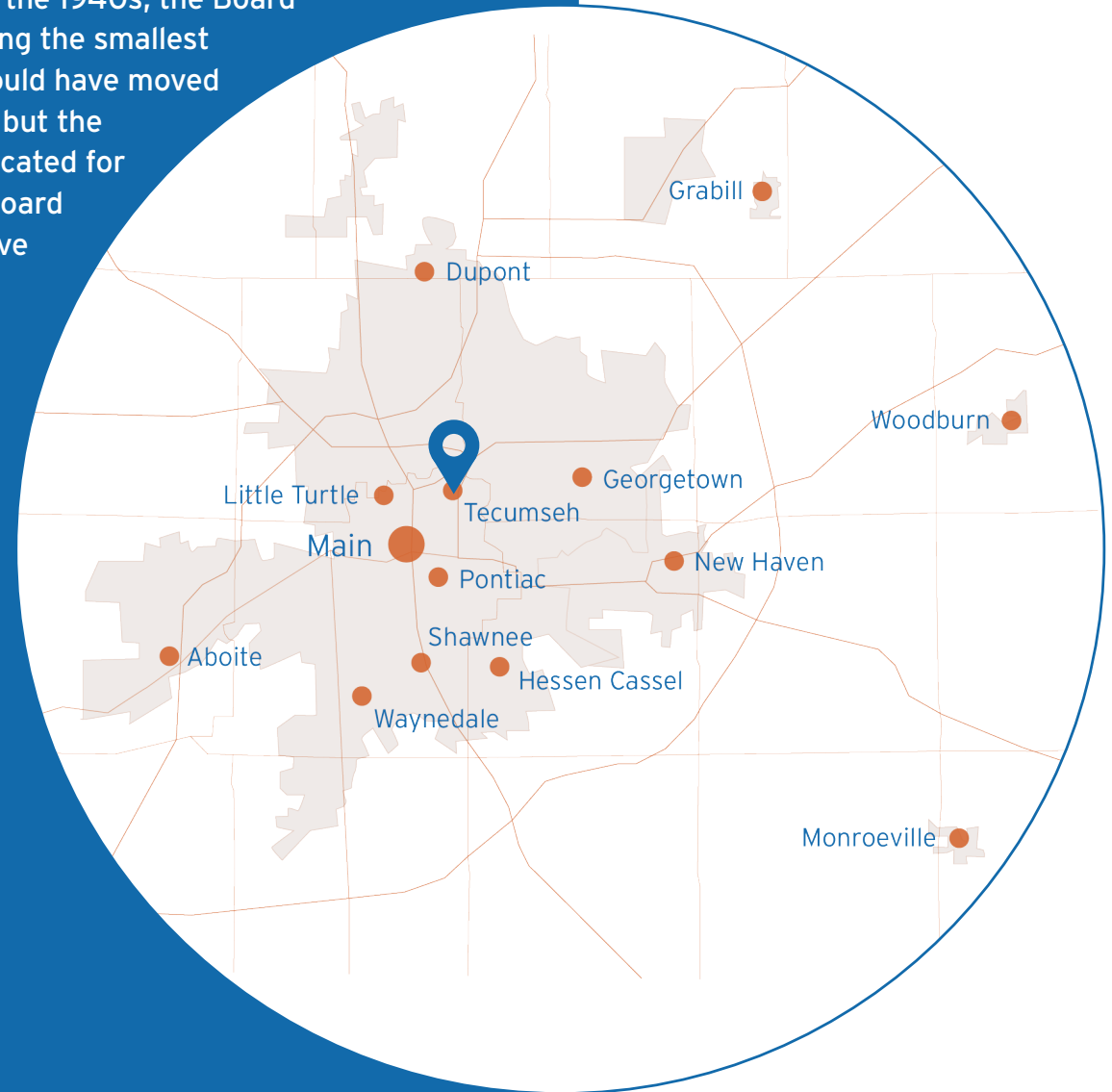

Regional Location Map

**Adequately sized for current service demands**

**Yes** No

**Overall building condition**

1 2 **3** 4 5

Scale: 1 = Poor to 5 = Good

**Site allows for future expansion**

**Yes** No

**Renovation and/or expansion can meet 10-year service demand**

**Yes** No

## SITE



The branch and library sign are easily visible from East State Boulevard. The building entrance is visible coming from the east, but the south (street-facing) façade has no windows and does not project a significant presence as a library.

The parking lot includes 42 spaces, easily accessed and obvious from the street, but problematic in that the entrance is adjacent to a smaller one-way parking lot with 14 spaces, and the large lot with 28 spaces requires pedestrians to walk around the building to enter.

The site has some green space to the west and at the southeast corner near the entrance, some of which has been used for programming and is planned to be developed into a Pollinator Prairie Garden. The parking lot west of the building was designed specifically to support events.

The property is not large enough to support any significant expansion. Some modest renovation could occur near the entrance or along the west wall.



-  main entrance
-  number of parking spaces
-  property line

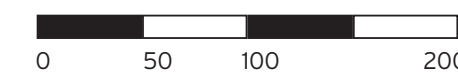

 Site Plan

## BRANCH CONDITION

The original branch (the east half of the current library) was completed in 1990. The branch was fully renovated and expanded into a former grocery store to the west in 2005. Tecumseh has not benefited from any major capital improvements since the renovation/expansion.

Major systems notes are informed by a January 2020 Trane Energy Contracting systems audit, as amended by ACPL facilities staff where applicable:

- The major equipment is in fair condition.
- The system includes central DX VAV air handling units served by boilers.
- Water heater is 15 years into a 15 year expected useful life and will soon need to be replaced.
- The boiler is 15 years into a 25 year expected useful life.
- The split system is 15 years into a 15 year expected useful life and will soon need to be replaced.
- The motors for both air handling units are 15 years into an 18 year expected useful life. ACPL has entered into a maintenance agreement to attend to these.
- Lighting is fluorescent throughout, no LED upgrades to date.

Additional observations:

- The building envelope is generally in good shape and has been well maintained.
- Finishes were updated in the 2005 and are showing signs of age.
- A survey prepared by Huntington University identified a few conditions that are non-compliant with the current applicable Americans with Disabilities Act.



**“Heat/cold are tricky because there’s nothing to block us from the bookdrop. I don’t want to face the wall to work, because we often work collaboratively.”**

*Staff Survey Response*

**“Having to walk from the large parking area all the way around the front of the building is really bothersome. I would love for the entrance to be on the other side of the building so that I can park and walk in without extra navigation. I would enjoy another table or sitting space separate from other patrons for reading or working (does not have to be another study room - just an open table). I would bring my laptop to avoid sitting on the log table of computers; I don’t want to be elbow-to-elbow with others while I work.”**

*Public Survey Response*





**"Space is an issue. We just don't have a lot of extra space to add computer workstations. Phone and cable TV comes into the branch at the Northeast corner of the building, everything has to be run from there."**

*Staff Survey Response*



# SPACE ALLOCATION

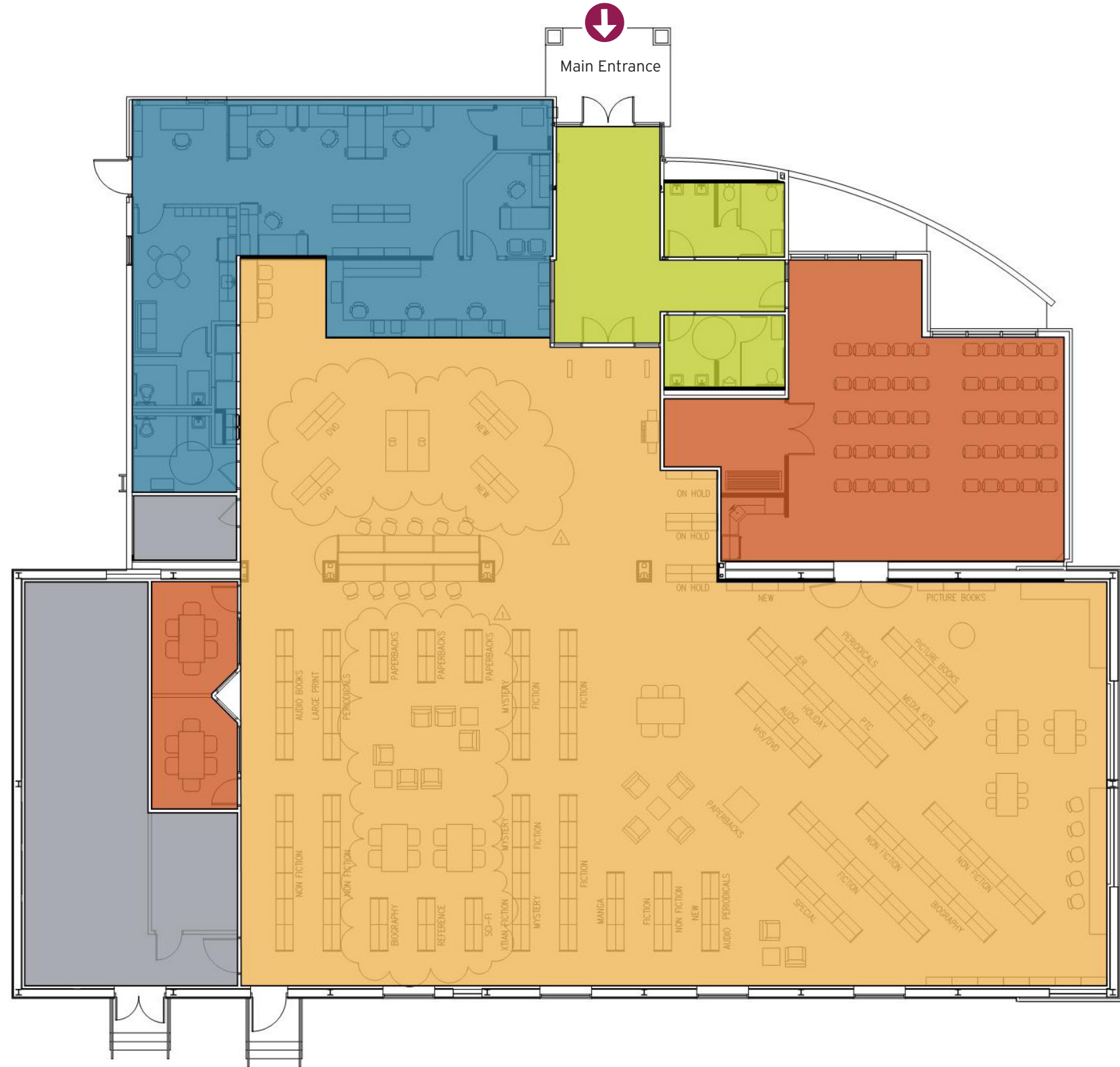
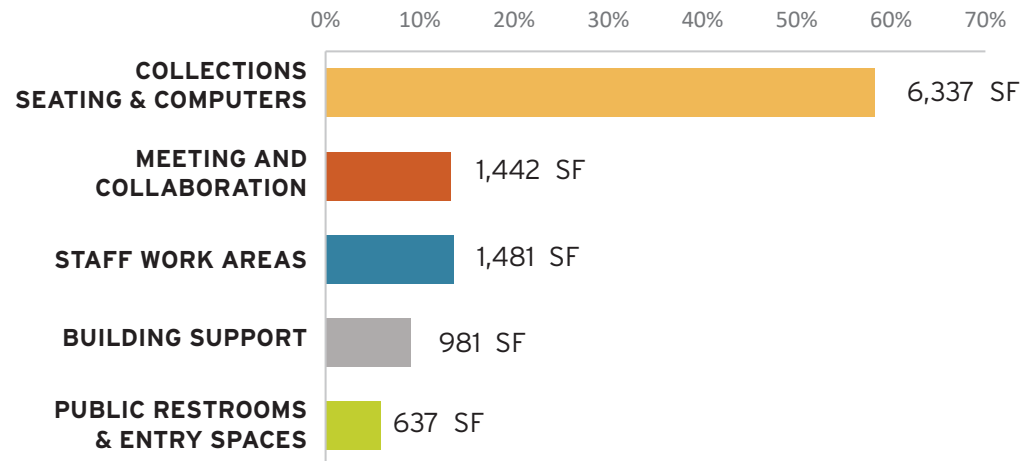



## FUNCTIONALITY

Tecumseh is adequately sized for the population served.

- The entrance vestibule feels oversized for the branch, but it is designed to provide access to the meeting rooms and restrooms.
- The branch layout is relatively simple and straightforward, and generally flexible except for the size limitations and the columns between the original branch and the expansion.
- The meeting room is approximately 1,000 SF, a good size for the branch, but the L-shaped arrangement limits flexibility. It includes an adequate presentation wall, but storage is shared for the entire facility and undersized as a result.
- The building was designed to accommodate after-hours meetings with restroom access.
- There is a café space adjacent to circulation area which is not well located and is underused.
- There is a family restroom near the café area, a positive amenity, but not well located for privacy.
- The children's space is appropriately sized for the community to be served, and its adjacency and access to the meeting room is a plus.
- The young adult space is small and centrally located in the open library and is not acoustically separated from the rest of the space.
- Two small study rooms are adequate and well located. The building could use more quiet space.
- The built-in computer area in front of circulation between the columns is functional but limits flexibility and some visibility.
- The layout and size of the branch do not adequately separate quiet and loud spaces.



## EFFICIENCY

- Tecumseh is adequately sized for the community served and volume of use.
- The circulation service point is oversized, with too many different functions occupying one location. The location is convenient to staff work areas but does not offer ideal sightlines.
- The staff work area is functional but too small and cluttered. There is storage located in some cabinets within the room, but no adequate dedicated storage room.
- The book return opens directly into the workspace. It should be enclosed for sound and safety..
- Staff workstations are near the exterior door. This makes it uncomfortable to work there when deliveries are being made, especially during bad weather.

**“Staff work area needs more space to accommodate the staff that works in the building. The space is cramped with as many desks as possible and shelves for reshelving books. There is no good way to fix this with the space given.”**

*Staff Survey Response*

# TECHNOLOGY

## Building Technology Infrastructure

- There are enough wired network connections.
- There are not enough power outlets for charging mobile devices, and outlets are not easy/comfortable to access.
- The existing space can accommodate expansion of power access needs.

## WiFi

- The existing WiFi covers: bandwidth needs for the library's computers; the physical space of the library for current usage; but not the needs of users outside the library building.

## Patron Computing

- There are no public computer stations with capabilities to support those with visual, auditory, or physical impairments.
- The Children's area does not have collaborative computing space for caregivers and children.

## Staff Computing

- There are not adequate computers or devices for staff.
- The existing printers/scanners/photocopiers are adequate.
- The existing phones are adequate for work needs.

## FF&E

- There are not enough computers to meet demand, patrons may experience wait times over 20 minutes during peak hours.
- There is a designated computer lab.
- There is adequate space at computer stations for patrons' items.
- There are no collaborative computing spaces.
- Some of the public computer workstations are ADA compliant.
- The Children's area has space for adult caregivers to work while supervising children in their care.
- There is no assistive listening technology in public meeting room.
- The audio/visual facility in meeting/study rooms is not meeting patron needs, and notes that patrons have requested public access projectors.

## Other/Additional Technology

- The library would like to add technology that supports a "roaming" service model.



**"Most of the issues are at the Children's computers, which has no line of sight. There isn't really a place to move these computers to be more in the line of sight for the Circulation desk."**

*Staff Survey Response*

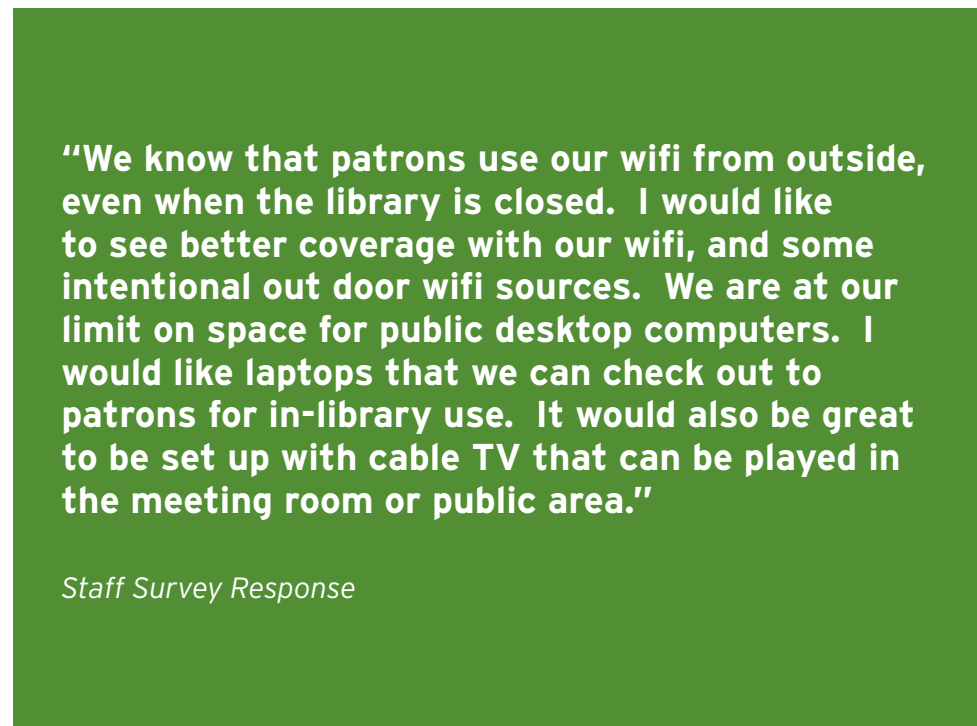

*Staff Survey Response*





**“Move reference desk (to see better) and make it minimalist so we can move it if we need to for programming or other big reason.”**

*Staff Survey Response*

## AMBIANCE

- The site is urban, but it has incorporated green space into the site in a positive way. The west parking lot includes red brick pavers which is a handsome material for parking.
- Finishes are aging and showing increasing signs of wear. The interior décor feels dated.
- The west half of the building benefits from a simple layout, higher ceilings, and decent lighting. The original east half includes most of the enclosed spaces and feels more crowded.
- There is some color in the branch, including color and murals specifically to enhance the children’s area.
- The acoustics can be problematic; loud and quiet spaces are not separated.
- The layout makes wayfinding straightforward given the open nature of the building, but there is little signage to support navigation.

**“I love the Tecumseh branch. Bigger is not always better. It is warm and inviting.”**

*Public Survey Response*

